

ORNAMENTAL IRON & ACCESSORIES



NOW AVAILABLE AT DILLON SUPPLY CO.



HAMMERED TUBING & BARS

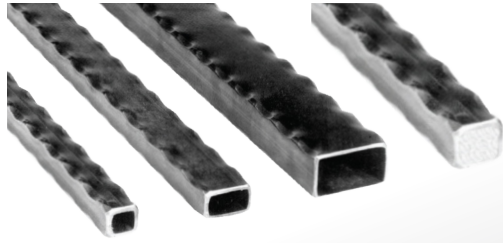

| DILLON # | MFR # | ITEM DESCRIPTION |
|----------|---------|--|
| 46611810 | 118/E/1 | TUBING: 3/4" SQUARE W/ HAMMERED EDGE, 20'L |
| 46611815 | 118/E/9 | TUBING: 1" SQUARE W/ HAMMERED EDGE, 20'L |
| 46611850 | 118/E/5 | TUBING: 1-1/2" SQUARE W/ HAMMERED EDGE, 20'L |
| 46611855 | 1374/15 | TUBING: 2" SQUARE W/ HAMMERED EDGE 20'L |
| 41811810 | 118/1 | BAR: 1/2" SQUARE HAMMERED BAR, 20' L |

WROUGHT IRON RAILS



| DILLON # | MFR # | ITEM DESCRIPTION |
|----------|-------|--|
| 42131148 | 114/8 | RAIL: HAMMERED EDGE 1-9/16 X 5/16", 118" L |
| 42131145 | 114/5 | RAIL: HAMMERED EDGE W/ DESIGN 1-9/16 X 5/16", 118" L |



| DILLON # | MFR # | ITEM DESCRIPTION |
|----------|--------|---|
| 42148100 | 48/1 | PICKET: 1/2" SQUARE W/ DOUBLE BASKET & TWIST, 35-7/16" H |
| 42148200 | 48/2 | PICKET: 1/2" SQUARE W/ SINGLE BASKET & TWIST, 35-7/16" H |
| 42151110 | 511/1 | PICKET: 1/2" SQUARE HAMMERED W/ 4-15/16" SCROLL, 35-7/16" H |
| 42165847 | 65/847 | PICKET: 1/2" SINGLE TWIST, 47" H |
| 42153347 | 53/347 | PICKET: 1/2" DOUBLE TWIST, 47" H |
| 42101132 | 113/2 | NEWELL POST: 1-3/16" SQUARE W/ BASKET TWIST, 43-1/4" H |

WROUGHT IRON BALUSTERS



HANDRAIL & CAPS



| DILLON # | ITEM DESCRIPTION |
|----------|------------------------------------|
| 42131606 | HANDRAIL CAP MOULDING 1606L 1"X20' |
| 42155606 | HANDRAIL CAP MOULDING 1"X20' |
| 42131607 | HANDRAIL MCR/112 2-1/4" W |

PUNCHED CHANNEL

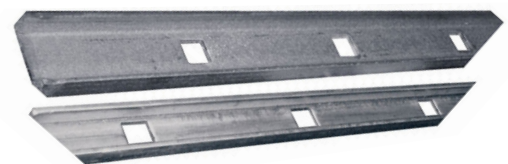

| DILLON # | ITEM DESCRIPTION |
|----------|--|
| 41251004 | 1 X 1/2 X 1/8 PUNCHED CHANNEL 9/16 SQ.4 CTR |
| 41251204 | 1-1/2 X 1/2 X 1/8 PUNCH CHANNEL 9/16 SQ.4CTR |

TO LEARN MORE ABOUT STEEL & METAL PRODUCTS CONTACT:
 24 Locations to Serve You | 1-800-849-3900 | www.dillonsupply.com



ORNAMENTAL IRON & ACCESSORIES



NOW AVAILABLE AT DILLON SUPPLY CO.



WROUGHT IRON SCROLLS



| DILLON # | MFR # | ITEM DESCRIPTION |
|----------|---------|---|
| 41280100 | 80/A/1 | S-SCROLL: W/ FORGED ENDS 1/2" X 1/4" |
| 41281200 | 80/A/12 | S-SCROLL: W/ FORGED ENDS 1/2" X 1/4" 2-3/4" X 7-1/2" |
| 41280300 | 80/A/3 | C-SCROLL: W/ FORGED ENDS 1/2" X 1/4" 2-3/8" X 4-5/16" |

WROUGHT IRON NEWELS



| DILLON # | MFR # | ITEM DESCRIPTION |
|----------|--------|-----------------------------------|
| 42181213 | 812/13 | LAMBS TONGUE FOR 811/7 (1-3/4" W) |
| 42181212 | 812/12 | LAMBS TONGUE FOR 811/6 (2-1/4" W) |

SPEAR POINTS



| DILLON # | MFR # | ITEM DESCRIPTION |
|----------|---------|---|
| 40212660 | 126/B/6 | SPEAR POINT: 1-3/4" WIDTH, 3-3/16" HEIGHT |

WROUGHT IRON RINGS



| DILLON # | MFR # | ITEM DESCRIPTION |
|----------|-------------|-------------------------------------|
| 40180089 | 491/8/D/89 | RING: 15/32" WIDTH, 3-1/2" DIAMETER |
| 40181270 | 491/8/D/127 | RING: 1/2" WIDTH, 5" DIAMETER |
| 40184910 | 491/8 | RING: 1/2" WIDTH, 3-15/16" DIAMETER |

CAST IRON BUSHING



| DILLON # | MFR # | ITEM DESCRIPTION |
|----------|---------|--|
| 40017461 | 746/1 | BUSHING: FITS 1/2" SQUARE 1-9/16" X 1-3/4" |
| 40068334 | CI68334 | BUSHING: FITS 3/4" SQUARE 2" X 2" |

WROUGHT IRON COLLARS

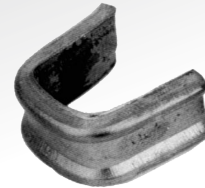

| DILLON # | MFR # | ITEM DESCRIPTION |
|----------|--------|--|
| 40015826 | 158/26 | 2 BARS OF COLLAR CLIP: FITS BARS 1/2" X 1/4" |



DILLON SUPPLY

TO LEARN MORE ABOUT STEEL & METAL PRODUCTS CONTACT:
24 Locations to Serve You | 1-800-849-3900 | www.dillonsupply.com